

TILLEDA FALLS CAMPGROUND

P.O. BOX 76
 W13165 COUNTY ROAD D
 TILLEDA, WI 54978
 WEB SITE: www.tilledafalls.com
 Phone: 715-787-4143
 FAX: 715-787-1344

BALLPARK ROAD

TO SHAWANO
 15 MILES

STATE HWY. 29

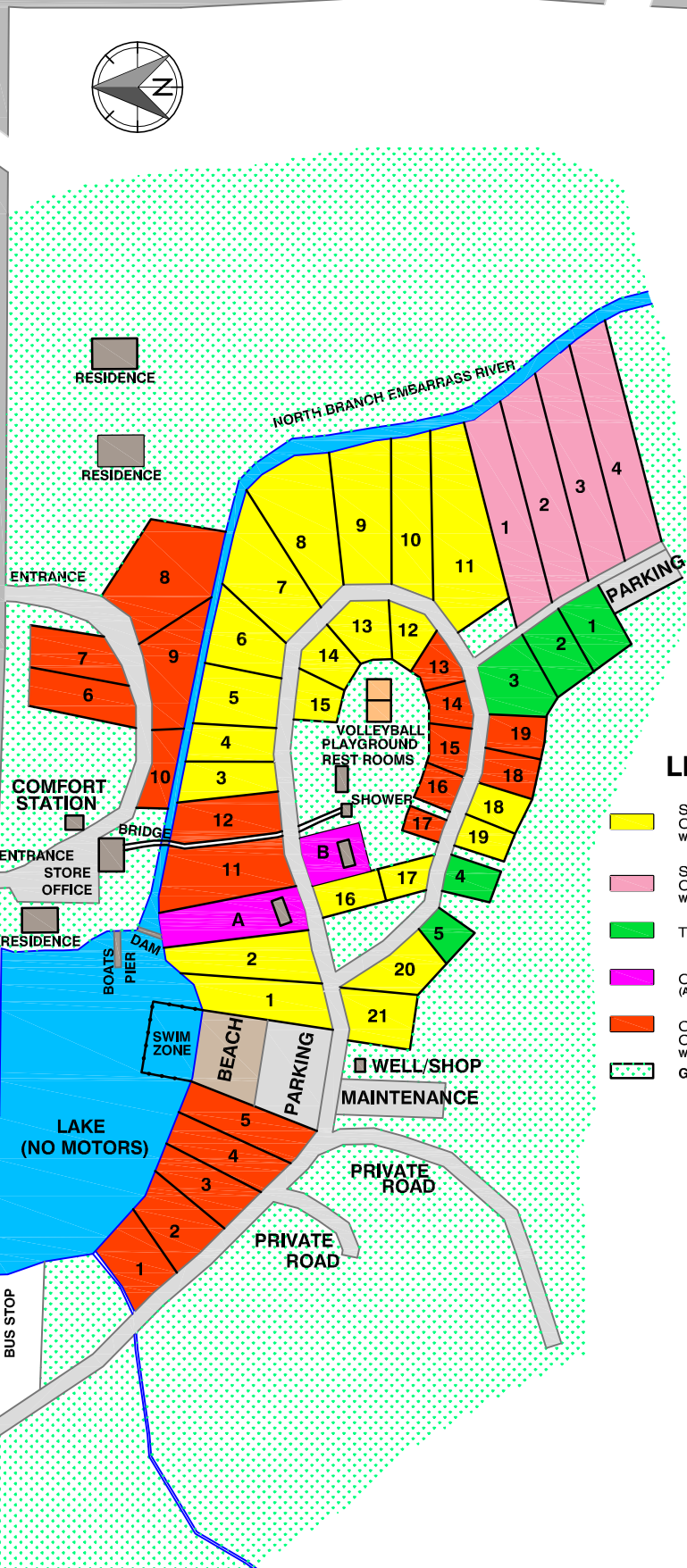
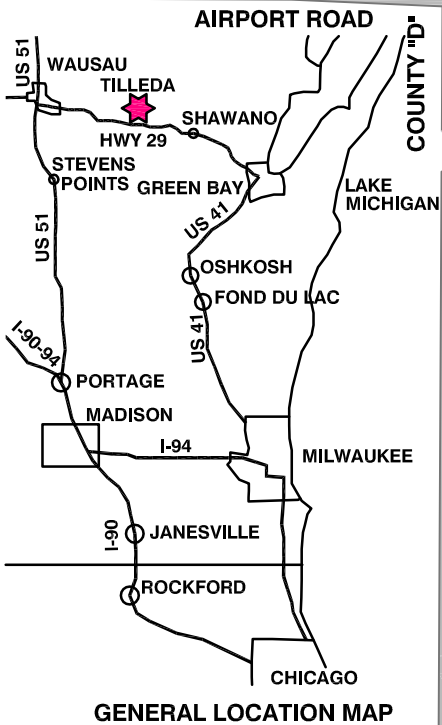

LEGEND

- SEASONAL CAMPSITES WITH WATER & ELECTRICAL
- SEASONAL CAMPSITES WITH WATER & ELECTRICAL
- TYPICAL TENT SITE
- CABIN SITE (A & B)
- OVERNIGHT CAMPSITES WITH WATER & ELECTRICAL
- GRASS/TREES

TO BOWLER

TO WAUSAU
 30 MILES

STATE HWY. 29